

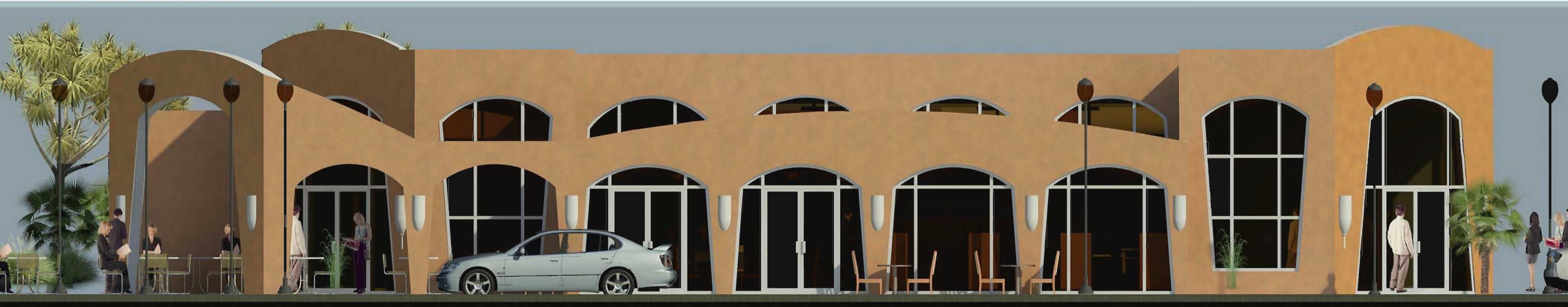

East Elevation



West Elevation



North Elevation

Arched openings throughout the fill-up panels create large expanses for glazing along the northern elevation that allow ambient light to reflect through the building.

Sustainability from the "Grounds" Up

2009 TCA Student Design Competition Sustainable Coffee Shop

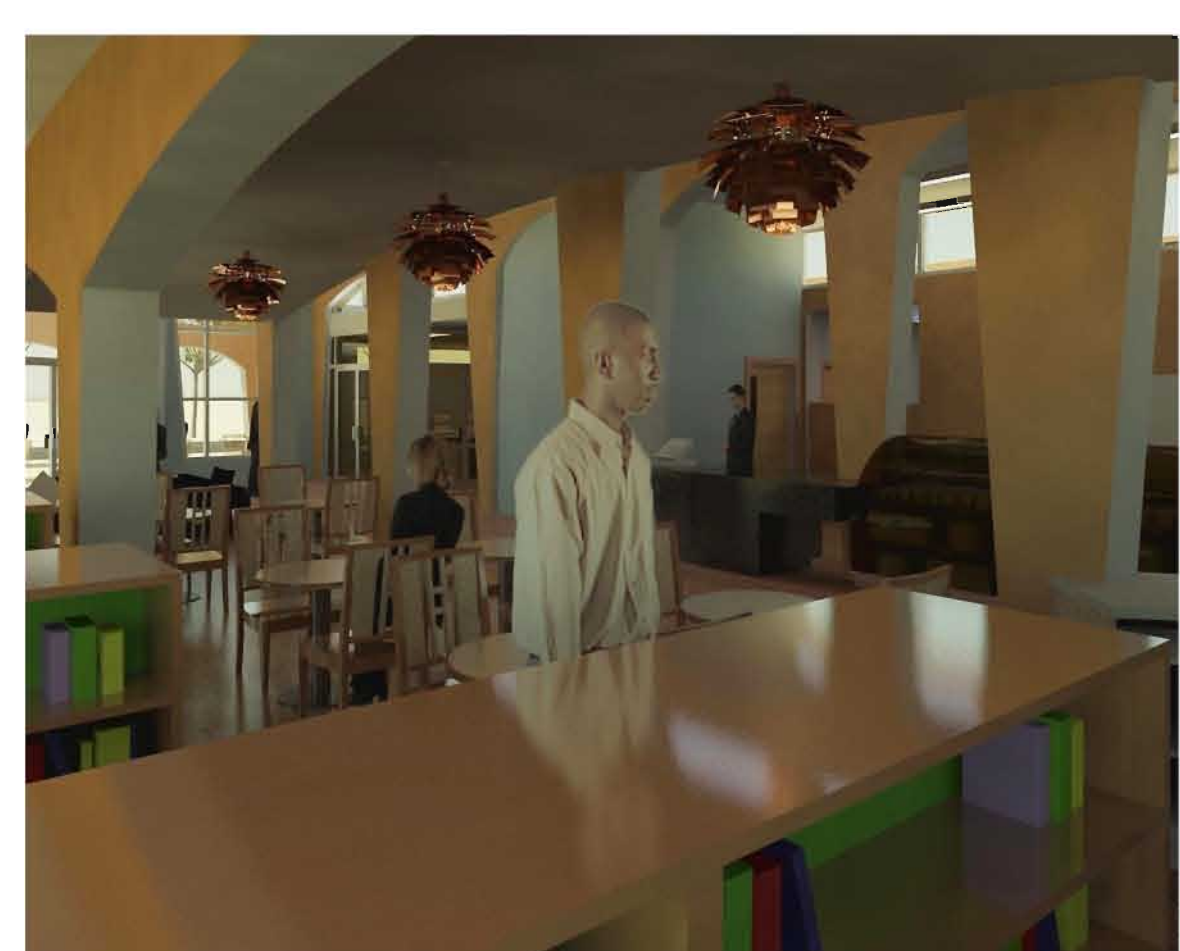

Site Plan

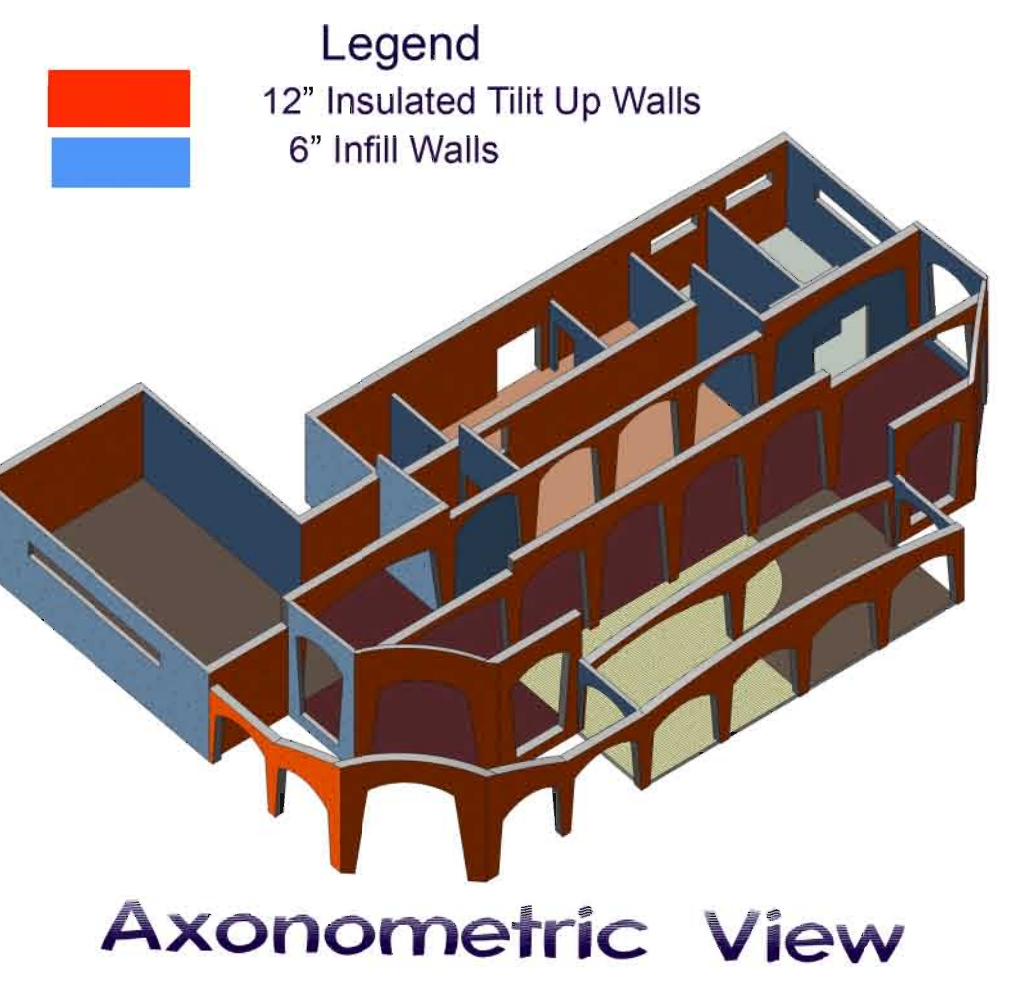

Legend
█ 12" Insulated Tilt Up Walls
█ 6" Infill Walls

Axonometric View

Columns formed create thermal masses that collect heat throughout the day and cool during the night to keep the structure cooler as the cold air is given off during the day and the warm air escapes through upper windows

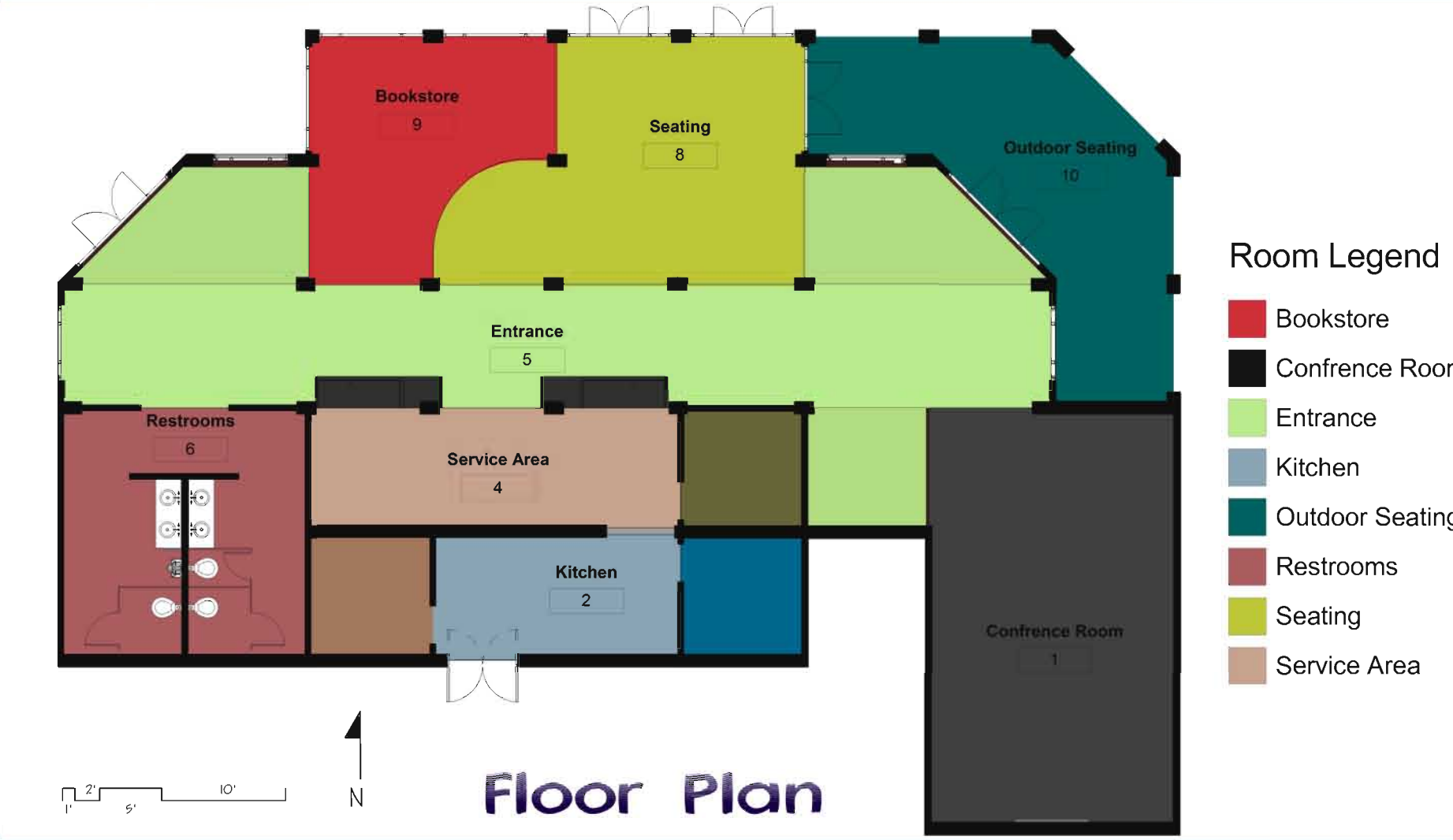

Floor Plan

- Room Legend
- █ Bookstore
 - █ Conference Room
 - █ Entrance
 - █ Outdoor Seating
 - █ Restrooms
 - █ Seating
 - █ Service Area

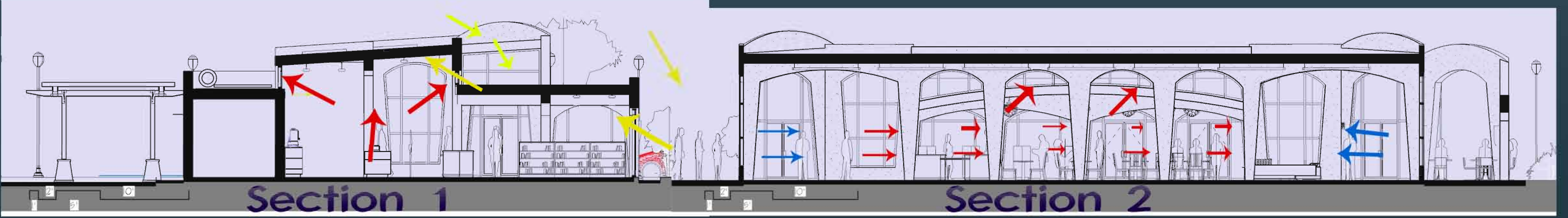

Section 1

Section 2

12" insulated Tilt-up concrete panels develop a skeleton of the building design. Tilt-up allows for large arched openings creating open but distinguished areas.

- Warm Air
- Cool Air
- Sun Light

